

Comfort system

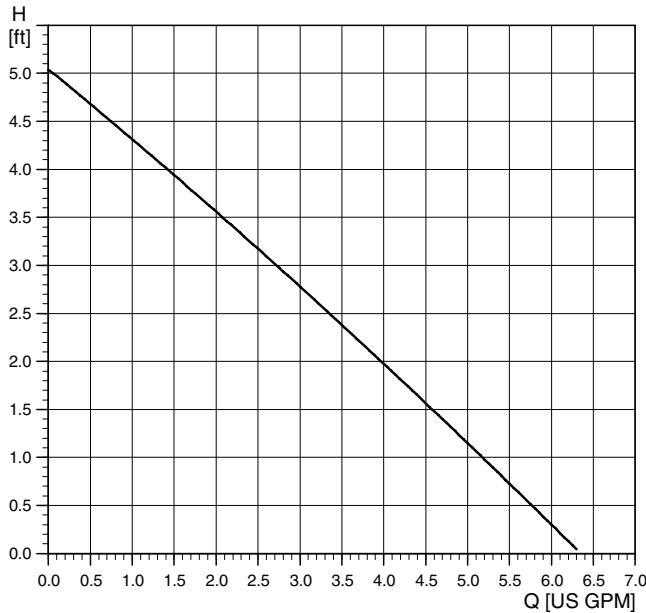

TM03 5547 3806

Flow range: 0-6.3 U.S. gpm
 Head range: 0-5.1 feet
 Motors: Single-phase
 Max. liquid temperature: 150 °F (66 °C)
 Min. liquid temperature: 36 °F (2 °C)
 Max. system pressure: 145 psi
 Open system

Model	Volts	Amps	Watts	Hp	Capacitor
UP 15-10SU7P/TLC	115	0.23	25	1/25	2µF/400 V

Approvals

- ANSI/NSF61
- IAPMO
- UPC
- UL.

UP 15-10SU7P/TLC

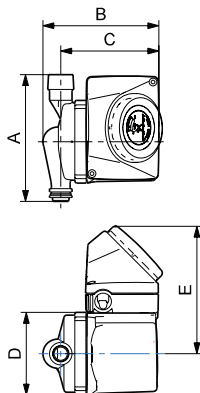

TM03 4362 3507

Comfort valve

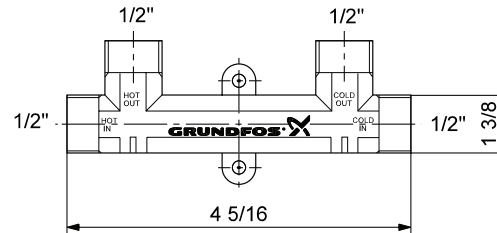

TM03 4363 3507

Model type	Product number	A	B	C	D	E	F	Connection type and size	Shipping weight [lbs]
UP 15-10SU7P/TLC	595916	5 7/16	6 1/4	5 1/2	3 7/16	3 1/4	4 4	3/4" M x 3/4" F NPT	5 1/2 lbs
Comfort valve	595926							1/2" M NPS (1/2" faucet)	2.8 lbs
Flex hose kit	599390							(2) 1/2" FIP x 1/2" FIP	-

Model type	Product number	Description
Comfort valves	595926	Box of 15 pieces
Comfort series kit	595916	1 pump and 1 valve, (2) 1/2" FNPS X 1/2" FNPS X 12" stainless steel flex hoses

Note: All models have a 10-foot 3-prong power cord.